

ARSCO SHORES

PART OF GOVERNMENT LOT 2, SECTION 2,
TOWNSHIP 147 NORTH, RANGE 25 WEST
ITASCA COUNTY, MINNESOTA

LOCATION MAP

SECTION 2, TOWNSHIP 147 NORTH, RANGE 25 WEST

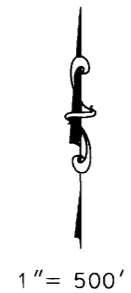
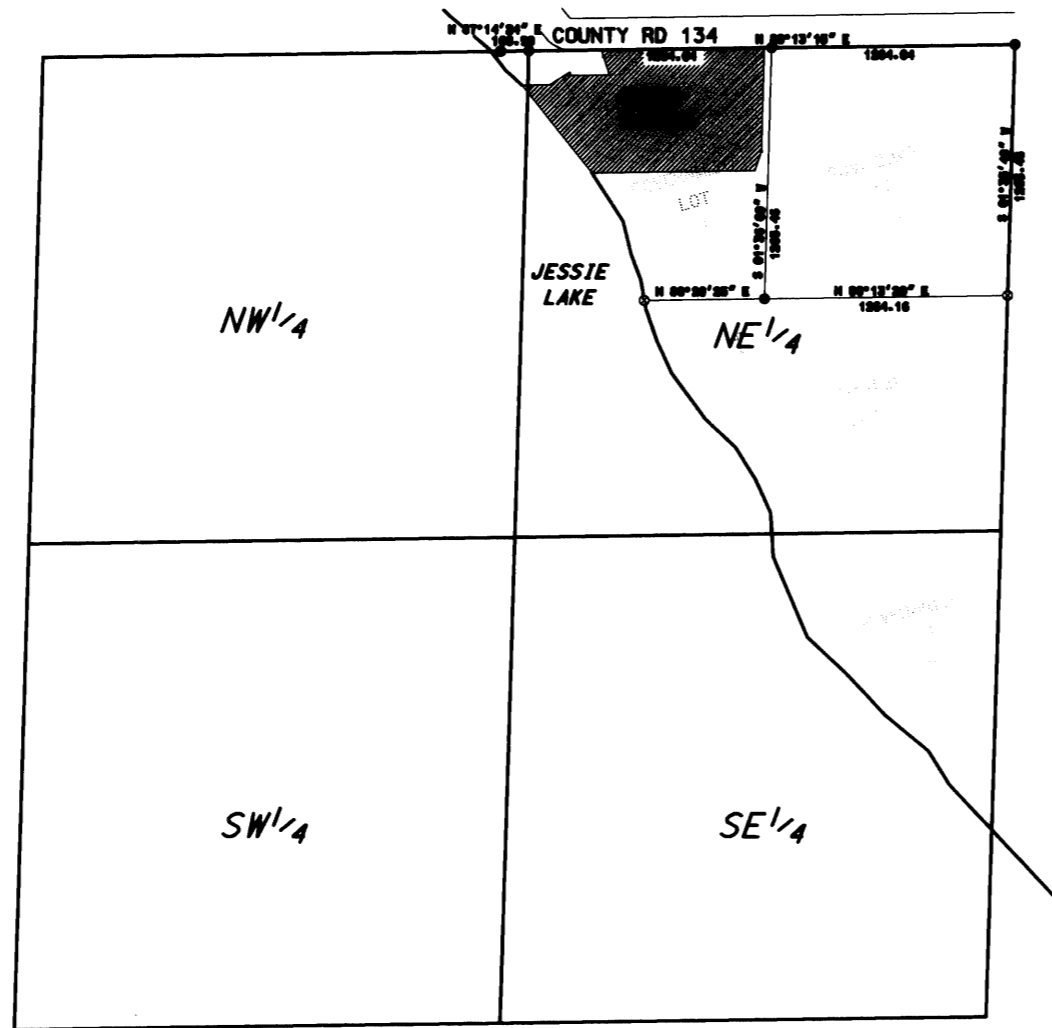

Prepared April 28, 2006 by: **SEH**

LEGEND

- SURVEY MONUMENT FOUND
- ⊙ COMPUTED POSITION BASED ON CERTIFICATE OF SURVEY NOS. 030700

PLAT DEDICATION
ARSCO SHORES
BOWSTRING TOWNSHIP, ITASCA COUNTY, MINNESOTA

KNOW ALL MEN BY THESE PRESENTS: That ARSCO LLC., a Minnesota Corporation, being the owners and proprietors of, and HIGHWAY FEDERAL CREDIT UNION, a Minnesota Corporation, being the mortgagor of the following described property lying and being in the township of BOWSTRING, County of Itasca, State of Minnesota, to-wit:

That part of the North 636 feet of Government Lot 2, Section 2, Township 147 North, Range 25 West, of the 5th Principal Meridian which lies Westerly of the following described line:

Commencing at the Northeast corner of Government Lot 2; thence South 89 degrees 43 minutes 50 seconds West a distance of 40.04 feet to the West line of the East 40 feet; thence South 02 degrees 08 minutes 50 seconds West, along said West line, a distance of 536.48 feet; thence South 18 degrees 38 minutes 07 seconds West a distance of 105.70 feet to the South line of the North 636 feet of Government Lot 2 AND which lies southerly and easterly of the following described line:

Commencing at the Northeast corner of Government Lot 2; thence South 89 degrees 43 minutes 50 seconds West, along the north line of said lot, a distance of 886.29 feet to the point of beginning; thence South 17 degrees 40 minutes 31 seconds East a distance of 136.24 feet; thence South 89 degrees 43 minutes 50 seconds West a distance of 200.00 feet; thence North 19 degrees 02 minutes 43 seconds West a distance of 17.24 feet; thence South 59 degrees 19 minutes 55 seconds West, a distance of 123.98 feet; thence South 89 degrees 43 minutes 50 seconds West, a distance of 170 feet, more or less, to the shore of Jessie Lake and there terminating.

Has caused the same to be surveyed and platted as ARSCO SHORES and does hereby dedicate to the public for public use forever a 33.00 foot easement for ingress egress along County Road 134.

IN WITNESS WHEREOF: said ARSCO LLC, a Minnesota Corporation, has caused these presents to be signed have hereunto set our hands this _____ day of _____, 2006

By: Bernard J. Arseneau, President Joseph B. Arseneau, Treasurer

STATE OF MINNESOTA)
) SS
COUNTY OF ITASCA)

The foregoing instrument was acknowledged before me this _____ day of _____, 2006, A.D. by Bernard J. Arseneau, & Joseph B. Arseneau

Notary Public, Itasca County, Minnesota
My Commission Expires _____

IN WITNESS WHEREOF: said HIGHWAY FEDERAL CREDIT UNION, Mortgagor, has caused these presents to be signed by its proper officers and its corporate seat to be hereunto affixed this _____ day of _____, 2006 A.D. by Jeff Schwalen, President

By: Jeff Schwalen, President

STATE OF MINNESOTA)
) SS
COUNTY OF ITASCA)

The foregoing instrument was acknowledged before me this _____ day of _____, 2006, A.D. by Jeff Schwalen, President

Notary Public, Itasca County, Minnesota
My Commission Expires _____

I hereby certify that I have surveyed and platted the property described as ARSCO SHORES, that this plat is a correct representation of said survey; that all distances are correctly shown on the plat in feet and hundredths of a foot, that all monuments are correctly placed in the ground as designated and boundary lines are correctly designated on the plat and there are no wetlands or public highways to be designated other than as shown.

John J. Hinzmann, Land Surveyor
Minnesota License No. 15294

Subscribed and sworn to before me this _____ day of _____, 2006, A.D. by John J. Hinzmann, Minnesota License No. 15294.

Notary Public, Itasca County, Minnesota
My Commission Expires _____

Pursuant to Minnesota Statutes, Chapter 389.08, Subd. 2, this CIC Plat has been reviewed and is approved this _____ day of _____, 2006

By: Timothy J. Wotzka, Itasca County Surveyor

We do hereby certify that on the _____ day of _____, 2006 A.D., the Board of Supervisors of Bowstring Township, Itasca County, Minnesota, approved the plat of ARSCO SHORES.

By: Timothy Schultz, Chairman Attest: Christine Schultz, Clerk

We do hereby certify that on the _____ day of _____, 2006 A.D., the Planning Commission/Board of Adjustment approved the plat of ARSCO SHORES.

By: Byron Snowden III, Planning Commission/ Board of Adjustment Chairperson Attest: Don Dewey, Environmental Services Administrator

I do hereby certify that there are no delinquent taxes on the above described property as of this _____ day of _____, 2006, A.D.

I do hereby certify that the taxes on the above described property have been paid in full the _____ day of _____, 2006, A.D.

Robert D. Zuehlke, Auditor/Treasurer
Itasca County, Minnesota

I hereby certify that the within instrument was filed in this office for record as Document No. _____ this _____ day of _____, 2006, A.D., at _____ o minutes/clock _____ m.

Jean Bengtson Winter, Recorder
Itasca County, Minnesota

ARSCO SHORES

PART OF GOVERNMENT LOT 2, SECTION 2,
TOWNSHIP 147 NORTH, RANGE 25 WEST
ITASCA COUNTY, MINNESOTA

LEGEND	
—	PLAT BOUNDARY
⊙	COMPUTED POSITION
●	SURVEY MONUMENT FOUND RLS #16089
○	SET 5/8" REBAR RLS #15294
---	SURVEY LINE
---	EASEMENT LINE
---	DELINEATED WETLAND
⊙	BENCHMARK - ALUMINUM MONUMENT ELEV = 1344.12 NGVD 88 DATUM

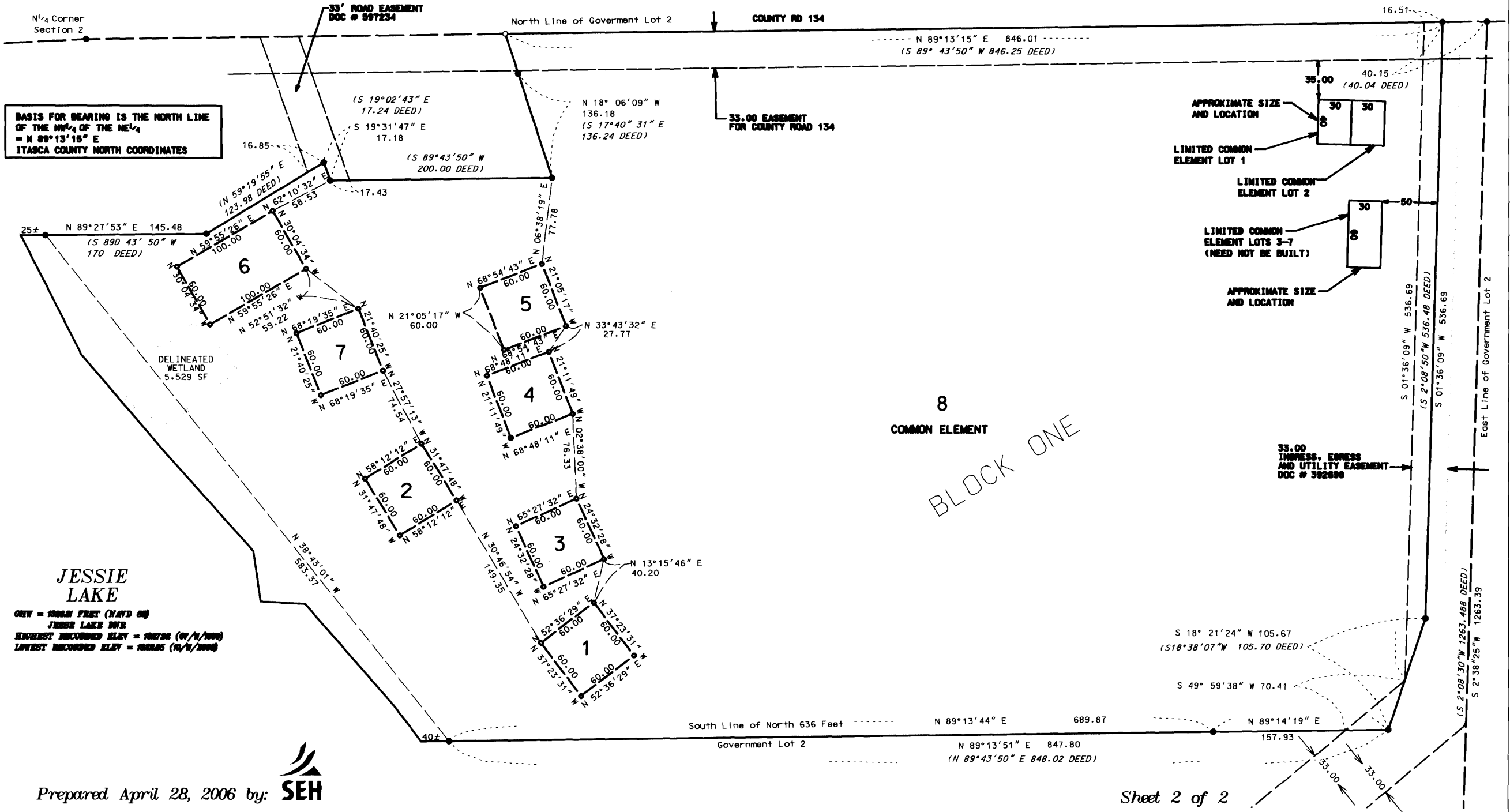
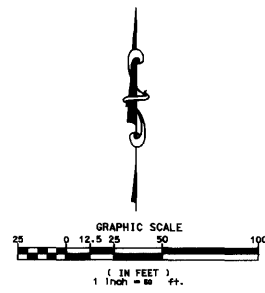

BASIS FOR BEARING IS THE NORTH LINE OF THE NW 1/4 OF THE NE 1/4 = N 89°13'15" E ITASCA COUNTY NORTH COORDINATES

JESSIE LAKE
 ORV = 1985N FEET (NAVD 88)
 JESSIE LAKE DNR
 HIGHEST RECORDED ELEV = 1007.06 (01/11/2000)
 LOWEST RECORDED ELEV = 1000.85 (10/11/2000)

Prepared April 28, 2006 by: **SEH**

Sheet 2 of 2