

THE COMMISSIONER OF TRANSPORTATION IS HEREBY DESIGNATING THE DEFINITE LOCATION OF TRUNK HIGHWAY NO. 38 FROM 0.2 MILES NORTH OF THE JUNCTION WITH COUNTY STATE AID HIGHWAY NO. 19 TO 1.5 MILES SOUTHEAST OF MARCELL

as shown on this plat prepared by the State of Minnesota Department of Transportation is hereby certified as the official plat of that portion of said T.H. 38 within the designated portion of Section 11 and the commissioner's Order, therefore, pursuant to Minnesota Statutes, Section 160.085, Section 160.14 subd. 1, Section 161.16 subd. 2, and Section 161.18.

It is further ordered that it is necessary to acquire all trees, shrubs, grass and herbage within the right of way of said Trunk Highway, and to keep and have the exclusive control of the same.

Commissioner's Order No. 95899 Location PLAT 31-168 Nature of Interest Definite location, width, access and temporary easement.

Certified by Charles A. Zelle, Commissioner of Transportation, dated 4/10/17, by Peter W. Jenkins, Assistant Director, Office of Land Management.

I hereby certify that this plat was surveyed and prepared by me or under my direct supervision and that I am a duly Licensed Land Surveyor under the Laws of the State of Minnesota; that all measurements are correctly shown on this plat; that all monuments have been correctly placed as shown on this plat; that Certificates of Location for the monumented Public Land Survey corners as shown on this plat are on file in the County Recorder's Office (if required under Minnesota Statutes, Section 160.15) and/or the County Surveyor's Office; that this plat meets the requirements of Minnesota Statutes, Section 160.085, Section 160.14 subd. 1, Section 161.16 subd. 2, and Section 161.18; that the parcel ownerships are correctly described and delineated on the plat; and that the proposed right of way boundary lines are correctly designated on the plat.

Certified by Kevin M. Sutherland, MNDOT District Office, License No. 50807, Date 4-13-17.

Table with 7 columns: PARCEL, OWNER, LOCATION, TORRENS NUMBER, NEW T.H. R/W, TEMPORARY EASEMENT, PERMANENT R/W INTEREST. Row 1: 62, UNITED STATES OF AMERICA, NW1/4 SE1/4 SE1/4 SE1/4 GOV'T LOT 6, 2347, 10.08, EASEMENT.

MINNESOTA DEPARTMENT OF TRANSPORTATION RIGHT OF WAY PLAT NO. 31-168

CONTROL SECTION NO. 3108 (38=196) 906 IN THE NORTHWEST QUARTER OF THE SOUTHEAST QUARTER OF SECTION 11, T.57 N., R.26 W., IN THE SOUTHEAST QUARTER OF THE SOUTHEAST QUARTER OF SECTION 11, T.57 N., R.26 W., IN GOVERNMENT LOT 6 OF SECTION 11, T.57 N., R.26 W., ITASCA COUNTY, MINNESOTA

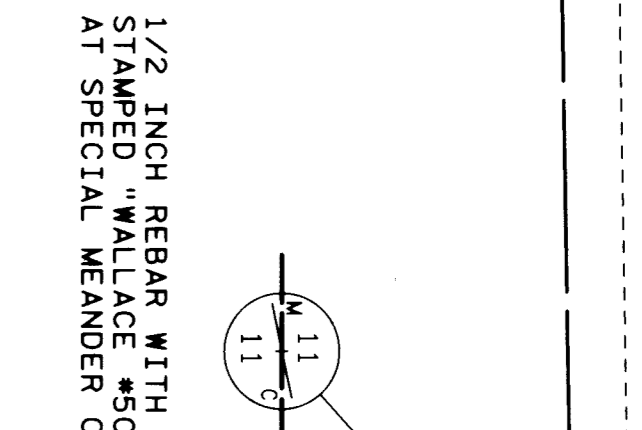
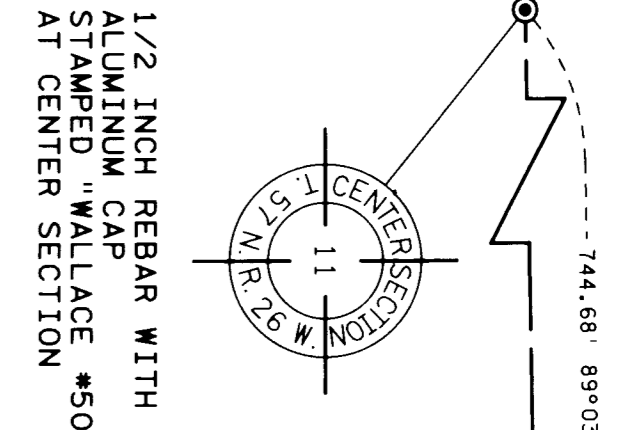
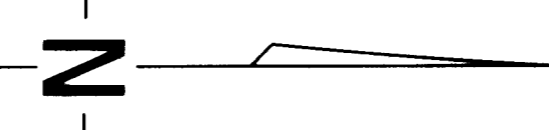
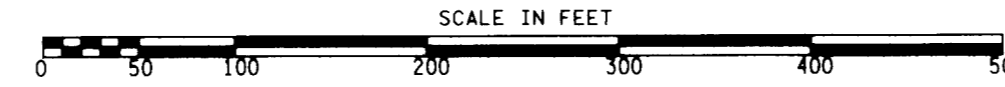

ITASCA COUNTY COORDINATES NORTH ZONE X=531874.573 Y=74216.655 NAD 83(2011 ADJ.)

MNDOT 2 INCH SQUARE STEEL TUBE AND CAST IRON CAP WITH BRASS INSERT AT EAST SIXTEENTH CORNER

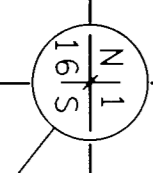

1-1/2 INCH IRON PIPE WITH ALUMINUM CAP AT SECTION CORNER

FOR BALANCE OF PAR. 62 SEE PLAT 31-166, PLAT 31-167, PLAT 31-172, PLAT 31-178, PLAT 31-180, PLAT 31-181, PLAT 31-183, PLAT 31-184, PLAT 31-185, PLAT 31-186, PLAT 31-187, PLAT 31-188 AND PLAT 31-189

SURVEY STANDARDS

- 1. The plat values, azimuths, and distances are based on the county coordinate survey system.
2. The boundary monuments shown on this plat have been field checked for location. The standard deviation for the monument position is 0.10 foot.
3. The county coordinates shown on one monument are based on ties to national control monuments.
4. Certificates of Location have been filed at the County Recorder's Office and/or the County Surveyor's Office for the section corner monuments shown on this plat.
5. For details of this survey contact the Surveying Section at the Minnesota Department of Transportation: DULUTH Name of District

CONVENTIONAL SYMBOLS

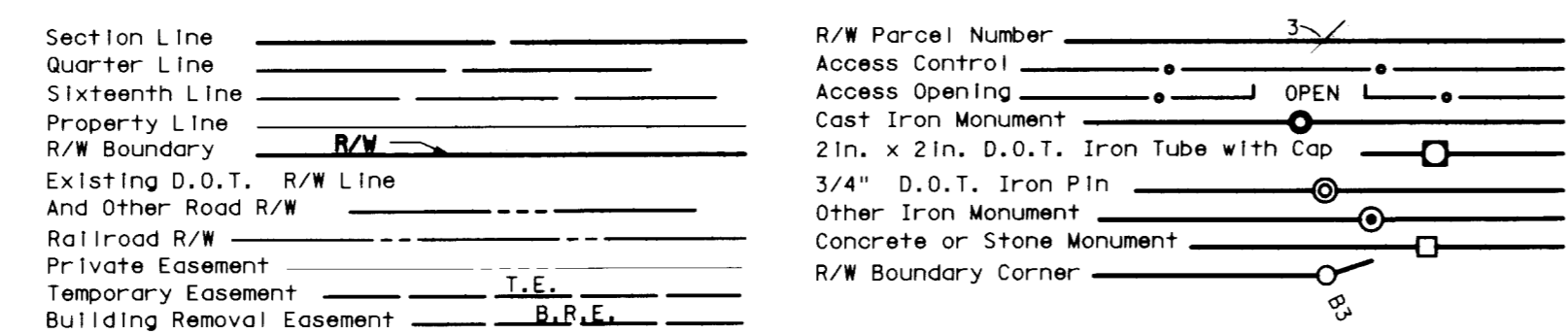

DISTANCES SHOWN TO FEET (66, 80 ETC.) ARE EXACT VALUES.

Table with 4 columns: FROM, TO, DISTANCE(FT), AZIMUTH. Lists boundary points B1 through B8 and distances/azimuths for various sections.

AZIMUTH ORIENTATION AND GRID CONVERSION Plat azimuths are oriented to the County Coordinate System with 0 degrees 0 minutes 0 seconds being 'GRID NORTH'. Plat distances are ground lengths.

PLAT NO. 31-168 C.S. 3108 (38=196) 906

DOC. NO. T000063246 OFFICE OF REGISTRAR OF TITLES ITASCA COUNTY, MINN I HEREBY CERTIFY THAT THIS PLAT HAS BEEN FILED IN THIS OFFICE ON April 13, 2017, AT 3:05 P.M. IN CAB. Nalle Zehner REGISTRAR OF TITLES