

### MINNESOTA DEPARTMENT OF TRANSPORTATION RIGHT OF WAY PLAT NO. 31-23

STATE PROJECT NO. 3114(71-4-45)  
IN THE EAST HALF OF SECTION 8, T. 150 N., R. 29 W.,  
ITASCA COUNTY, MINNESOTA

THE COMMISSIONER OF TRANSPORTATION IS HEREBY DESIGNATING THE DEFINITE LOCATION OF TRUNK HIGHWAY NO. 71 FROM THE WEST ITASCA COUNTY LINE TO THE NORTH ITASCA COUNTY LINE.

As shown on this plat prepared by the State of Minnesota Department of Transportation is hereby certified as the official plat of that portion of said T.H. 71 within the designated portion of Section 8 and the Commissioner's Order therefor, pursuant to Minnesota Statutes, section 161.16 subd. 2, section 160.14 subd. 1, section 160.085, and section 161.18.

Commissioner's Order No.	Location	Nature of Interest
73968	PLATS 31-21 THRU 31-25	Definite location, width, access, temporary easement and building removal easement.

Recommended for Certification Certified

Leonard J. Levine  
Commissioner of Transportation  
Date: 10-17-88  
by E.E. O'Connell  
Assistant Commissioner of Transportation

I hereby certify that this plat was prepared by me or under my direct supervision and that I am a duly Registered Land Surveyor under the Laws of the State of Minnesota; that this plat meets requirements of Minnesota Statutes, section 161.16, Subd. 2, section 160.14, Subd. 1, section 160.085, and section 161.18; that parcel ownerships are correctly described and delineated on the plat; and that the proposed right-of-way boundary lines are correctly designated on the plat.

Certified by: *John E. Jensen* 10460 10-17-88  
Registered Land Surveyor Reg. No. Date  
Office of Right of Way & Surveys

I hereby certify that this plat was surveyed by me or under my direct supervision and that I am a duly Registered Land Surveyor under the Laws of the State of Minnesota; that all measurements are correctly shown on this plat; and that all monuments have been correctly placed as shown on this plat.

Certified by: *William R. W. W. W.* 11166 10/21/88  
Registered Land Surveyor Reg. No. Date  
MVDOT District Office

#### PLAT BOUNDARY DATA

POINT	DISTANCE	AZIMUTH
B209-B1	1321.26'	21°01'07"
B1-B2	25.00'	291°01'07"
B2-B3	116.48'	21°01'07"
B3-B4	Δ 13°36'31" R	2671.48'
C	633.03' CAZ 27°29'22" ARC	634.52'
B4-B5	Δ 7°32'57" R	2671.48'
C	351.74' CAZ 38°24'07" ARC	351.99'
B5-B6	Δ 7°54'31" R	2671.48'
C	368.46' CAZ 46°07'51" ARC	368.75'
B6-B7	26.99'	321°22'20"
B7-B8	Δ 48°01'28" R	277.04'
C	229.87' CAZ 296°51'36" ARC	237.04'
B8-B9	60.30'	272°20'52"
B9-B10	74.55'	295°45'53"
B10-B11	33.02'	0°44'22"
B11-B12	33.02'	0°43'07"
B12-B13	74.38'	73°13'56"
B13-B14	60.30'	92°20'52"
B14-B15	Δ 48°01'28" R	397.04'
C	329.45' CAZ 116°51'36" ARC	339.72'
B15-B6	26.99'	141°22'20"
B16-B17	Δ 11°24'28" R	2671.48'
C	531.02' CAZ 58°21'47" ARC	531.90'
B17-B18	459.99'	64°04'00"
B18-B19	18.27'	334°04'00"
B19-B20	Δ 27°08'32" R	595.87'
C	279.65' CAZ 347°38'16" ARC	282.28'
B20-B21	109.98'	112°34'
B21-B22	205.68'	14°42'21"
B22-B23	33.00'	91°12'31"
B23-B324	872.89'	180°53'07"
B324-B25	312.93'	244°04'00"
B25-B26	32.36'	244°04'00"
B26-B27	Δ 43°02'53" R	2421.48'
C	1776.84' CAZ 222°32'34" ARC	1819.33'
B27-B28	25.00'	291°01'07"
B28-B210	1369.43'	201°01'07"
B210-B209	211.35'	272°09'40"

#### SURVEY STANDARDS

- The plat values, azimuths, and distances are based on the project control survey system.
- The boundary monuments shown on this plat have been field checked for location. The standard deviation for the monument position is 0.10 feet.
- The state plane coordinates shown on one monument are based on ties to national control monuments.
- Certificates of Location have been filed at the County Recorder's Office and/or the County Engineer's Office for the section corner monuments shown on this plat.
- For details of this survey contact the Surveying and Mapping Section of the Minnesota Department of Transportation BE MIDJ1  
Name of District

#### AZIMUTH ORIENTATION AND GRID CONVERSION

Plat azimuths are oriented to Minnesota State Plane Coordinate System with 0 degrees 0 minutes 0 seconds being GRID NORTH.  
Plat distances are ground lengths and can be converted to Minnesota State Plane Grid lengths by multiplying Plat distances by 0.9998425.

#### CONVENTIONAL SYMBOLS

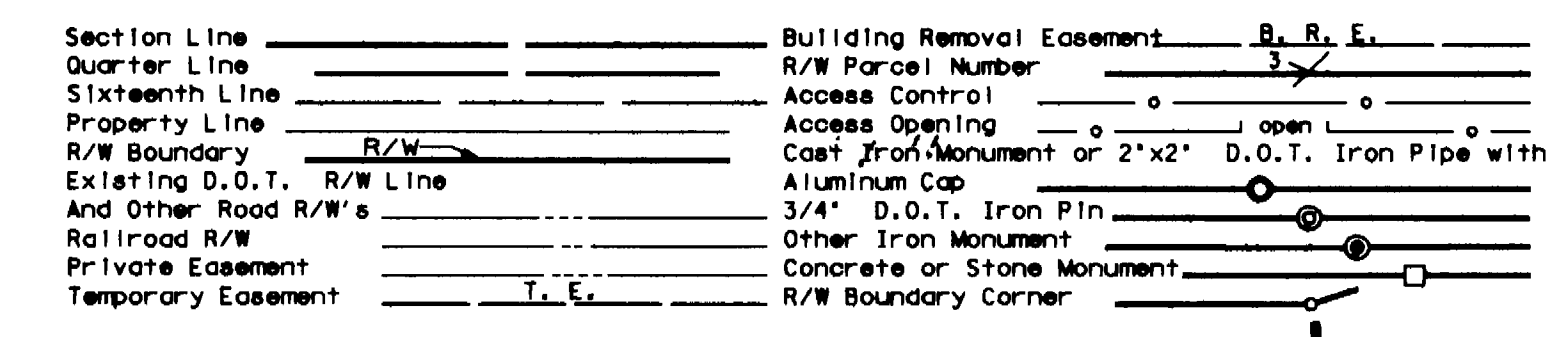

DISTANCES SHOWN TO FEET ( 66, 80 ETC. ) ARE EXTRINSIC VALUES.

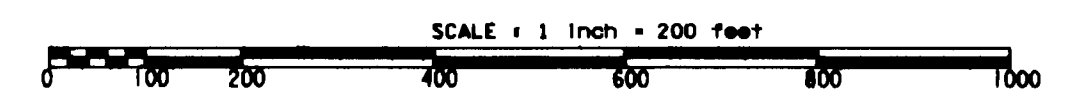

#### RIGHT OF WAY IN SECTION 8

PARCEL	OWNER	LOCATION	TOWN'S CERTIFICATE NO.	NEW T.H. R/W	TEMPORARY EASEMENT ACRES (MORE OR LESS)	BUILDING REMOVAL EASEMENT EXPIRES ON	PERMANENT R/W INTEREST
207	DUANE O. NELSON	NW1/4SE1/4		1.92	0.20	12-1-93	FEE
208A	STATE OF MINNESOTA	NE1/4SE1/4		8.12	0.81	12-1-93	FEE
209A	HARLOW E. BERGSTROM	SW1/4SE1/4		1.63	0.64	12-1-93	FEE
210	HARLOW E. BERGSTROM	NE1/4SE1/4		0.12	0.17	12-1-93	FEE
210A	JACQUELINE M. OLSON	SE1/4NE1/4		3.96	1.27	12-1-93	FEE

ITASCA COUNTY CAPPED 1-1/2\"/>

ITASCA COUNTY CAPPED 1-1/2\"/>

DOC. NO. 399414  
OFFICE OF COUNTY RECORDER  
ITASCA COUNTY, MINN.  
I HEREBY CERTIFY THAT THIS PLAT HAS BEEN FILED IN THIS OFFICE AT 2:00 O'CLOCK P.M. ON 10/21/88 IN BOOK 158 PAGE 438  
COUNTY RECORDER